

SECTION

111-4

ALUMINUM COPPER
CLAD TRANSITION PLATES

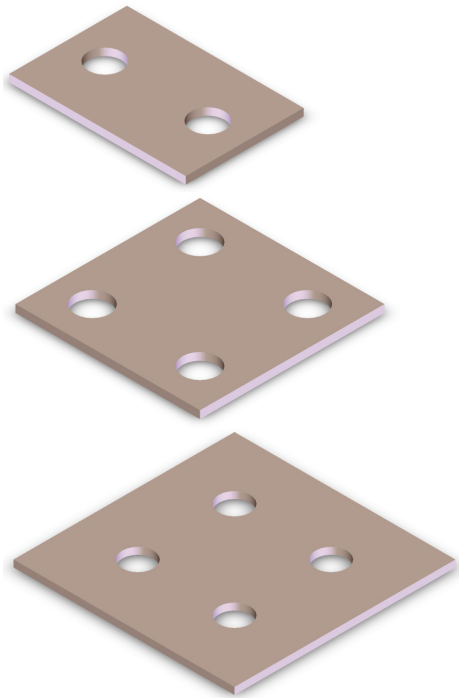

ALUMINUM COPPER CLAD TRANSITION PLATES		
CATALOG NUMBER	PAD EQUIVALENT	THICKNESS IN INCHES
TP2	B	1/16
TP3	C	1/16
TP4	D	1/16

Transition Plates

These 80% aluminum 20% copper clad plates provide ideal transitions when making aluminum to copper connections with flat pads and bars. The spacing of the holes adhere to NEMA standards and have a thickness of 1/16". Contact sealant is recommended

TP2
(TWO HOLE PAD)

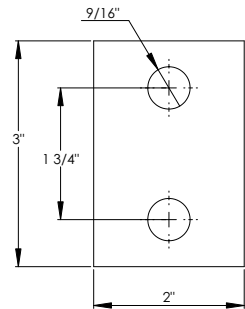

TP3
(FOUR HOLE PAD)

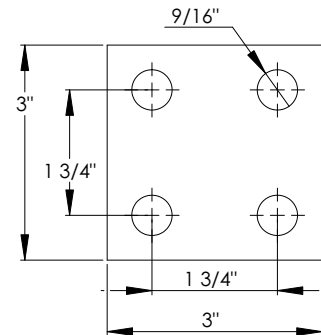

TP4
(FOUR BY FOUR PAD)

