

The pad to pad trifurcating connectors are cast of a high strength aluminum alloy and are capable of providing a corona free environment up to 500KV. Mounting hardware and hardware shields are available but must be ordered separately. Contact sealant is recommended. If a hardware shield is desired with the part simply add the suffix W1S

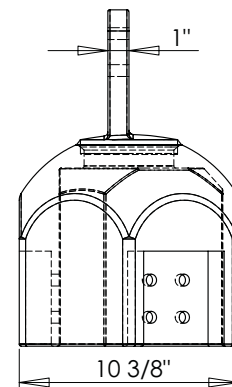
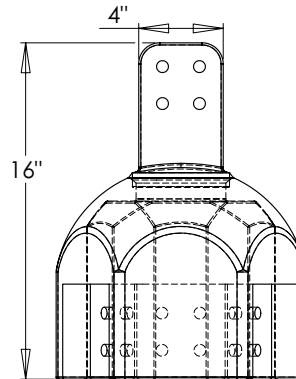
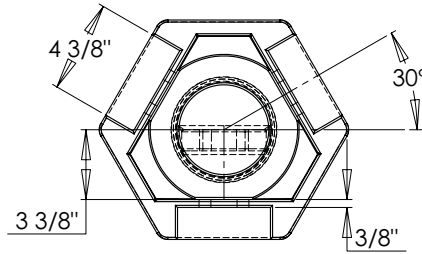

TRIFURCATING TERMINAL SINGLE TO TRIPLE FLAT PADS	
CATALOG NUMBER	PAD STYLE
TAT-9-EHV	D